

# Cangzhou Changyuan Fittings Co.,Ltd

Add:No.26 Shigang Road,Development Zone,Cangzhou ,Hebei,China Pc:061000

[Http://www.con-well.com](http://www.con-well.com) email:con-well@vip.163.com

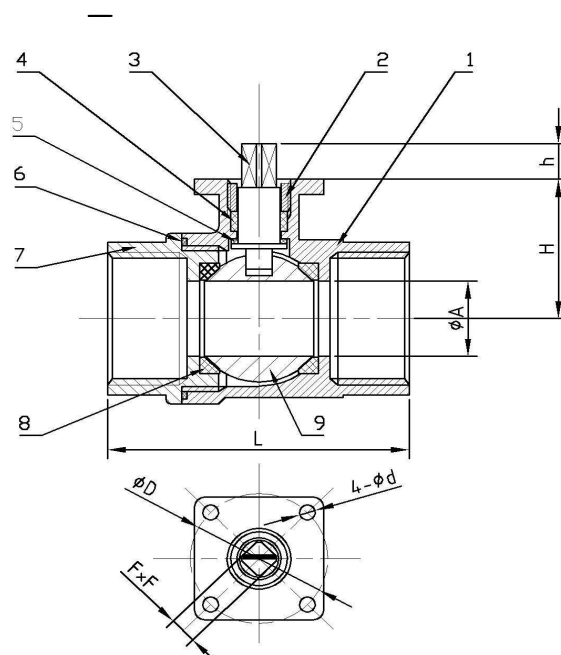

## 2PC BALL VALVE WITH MOUNTING PAD ISO5211 (FULL PORT) (mm)

DN	H	h	A	L	D	d	F
15	34.50	7.0	15.0	57.0	36.0	6.0	9
20	38.50	8.0	20.0	64.0	36.0	6.0	9
25	42.50	8.0	25.0	75.0	36.0	6.0	9
32	47.50	9.0	32.0	88.0	36.0	6.0	9
40	57.50	16.0	38.0	95.0	50.0	7.0	14
50	65.00	16.0	50.0	119.0	50.0	7.0	14

## MATERIAL LIST

ITEM	DESCRIPTION	MATERIAL
1	BODY	CF8/CF8M
2	GLAND NUT	304
3	STEM	304
4	STEM PACKING	PTFE
5	STEM SEAL	PTFE
6	BODY SEAL	PTFE
7	CAP	CF8/CF8M
8	BALL SEAT	RPTFE
9	BALL	304/316

## FEATURES:

- Working pressure:1000PSI(PN64).
- Working temperature:-10℃ to 150℃.
- Suitable medium:W.O.G.
- Thread: BSP,BSPT,DIN,NPT.
- PED97/23/EC(CE0038)Approved.
- Inspection Testing:API598,EN12266.